

Directions for using Crystal Applicator Tool and 4 Piece Snap Die Set (Item SN001)
 Designed to be used with Swarovski ELEMENTS part numbers as listed in Fig. 3
Please read directions carefully.

Refer to Fig. 1

1. Identify (A) upper and (B) lower die holders on tool.
2. Ensure tool handles can be closed completely.
 If necessary adjust with (C) stroke adjustment.

Refer to Fig. 2 & 3

3. To apply front of snap to material, identify FRONT DIE SET (SN001F) and attach upper and lower dies to die holders A and B on tool.
4. Insert Swarovski 'snap front' components in appropriate Front Dies. This operation includes the decorative snap front. (To match correct dies and components, see details in Fig. 2)
5. Place material **face down** over lower die and squeeze handles, attaching stone to material. Release tool and gently pull material to remove from tool.
6. To apply back of snap to material, remove upper and lower dies and repeat steps 3-4 with BACK DIE SET (SN001B) and 'snap back' components.

- IMPORTANT:** For bracelet application, be sure material is **face up** when performing this operation.
7. Release tool and gently pull material to remove from tool. Front and back snaps are now applied.
 8. Wear and enjoy!

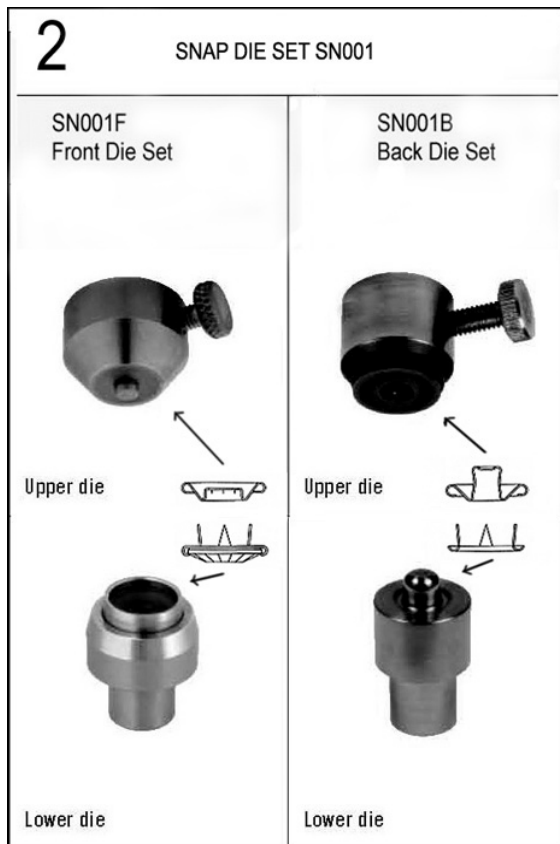
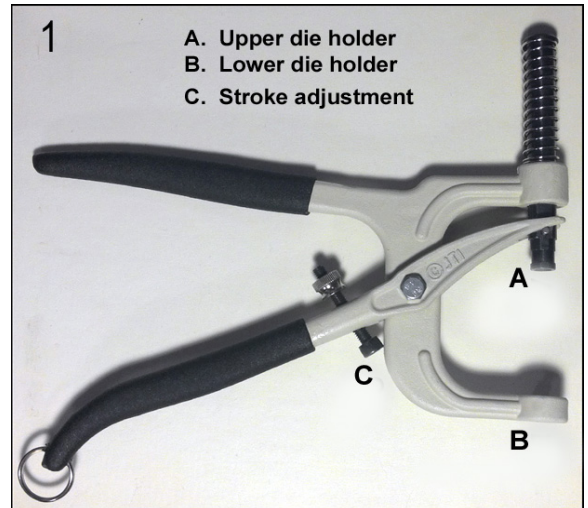

3 Swarovski Snap Die parts for use with SN001 Die	
1780/100 1780/114 1781/100 1781/114	1780/100 1780/114
SNAP FRONT (STONE)	SNAP BACK

